

Note: Improvements on this lot are not in a flood hazard area.

OAK FERN DRIVE
WATER & SEWER IN ST B/W

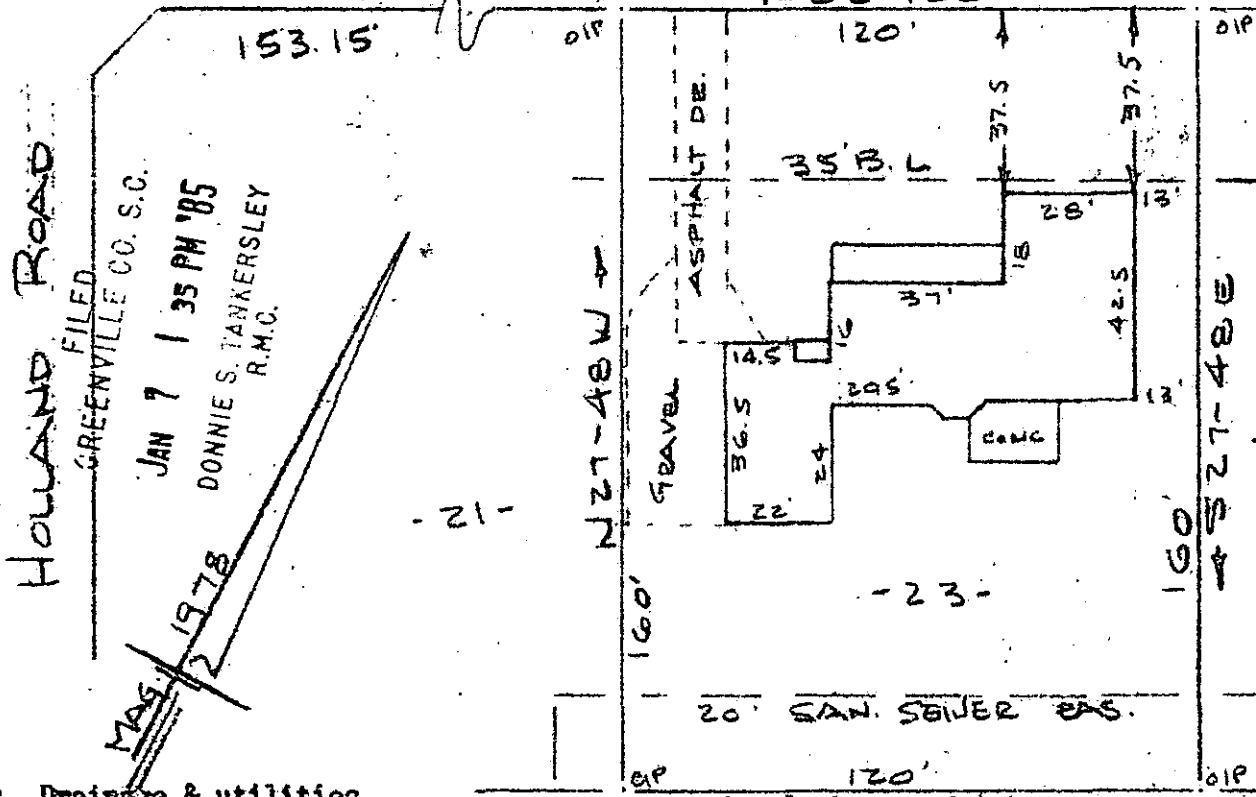

Note: Drainage & utilities easement 5' each side of all side and rear lot lines.

- SEE ONE OAKFERN -

PROPERTY OF
DAVID L. HEADRICK & MILLIE L. HEADRICK
NEAR GREENVILLE, S.C.

SCALE: 1" = 40' 2 JAN 1985

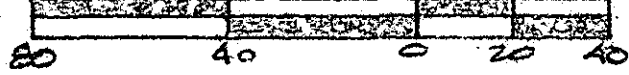

This is to certify that on the 2nd day of January, 1985, I surveyed the property shown on this plat, being known as lot 23 on plat of SECTION TWO OAKFERN and recorded in the REC Office Greenville County, S. C., in Plat Book "6 - H" at Page 53; and that the property lines, walls and buildings are as shown hereon, and that the walls and buildings located on said lot do not encroach or project on adjacent street or property, and that no adjacent walls or buildings encroach or project on said premises, and no power lines cross this property except as shown hereon.

11E-14

20139 ✓

R. B. Bruce
R. B. Bruce, RLS # 1952

JAN 7 1985

CAROLINA SURVEYING CO.
112 Hanly St.
Greenville, S. C.

Recordable Plat

FILED 1 JAN 07 85 020 3.00CTN

257/AD

291-1-72